

- PILOT DEVICE LEGEND
LEFT FLANGE**
- L1. SWITCH IN EMERGENCY LIGHT
 - L2. PUSH TO TEST BUTTON
 - L3. SWITCH IN NORMAL LIGHT
 - L4. EMERGENCY ISO SW. OPEN LIGHT

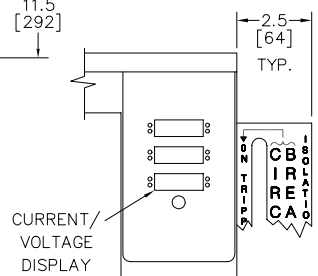

- PILOT DEVICE LEGEND
RIGHT FLANGE**
- R1. START PUSH BUTTON
 - R2. STOP PUSH BUTTON
 - R3. POWER ON LIGHT
 - R4. PHASE REVERSAL LIGHT

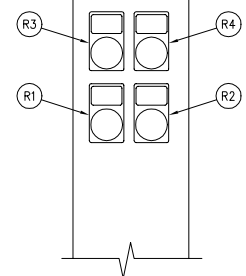
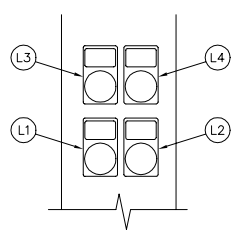

VOLTAGE	HORSEPOWER
200V	15-50 HP.
208V	15-50 HP.
230V	15-60 HP.
380V, 415V	15-75 HP.
460V	15-125 HP.

NOTES:
ALL DIMENSIONS IN INCHES AND MILLIMETERS ()

ENCLOSURE DIMENSIONS MODEL M450 W/TRANSFER SWITCH 64" CABINET ELECTRIC FIRE PUMP CONTROLLER	DRAWN SR 2-10-98 CHECK KH. 2-21-98 APPD J.C.B. 2-21-98	METRON, INC. DENVER, CO.
	CD32935B	
	SCALE N.T.S. SHEET 1 OF 1	